



Instruction Manual

Rainbow Colours Axolotl Teether



VTech understands that a child's needs and abilities change as they grow and with that in mind we develop our toys to teach and entertain at just the right level...

Pre-School

Interactive toys to develop their imagination and encourage language development

vtech Baby

Toys that will stimulate their interest in different textures, sounds and colours

I am...

...responding to colours, sounds and textures

...understanding cause and effect

...learning to touch, reach, grasp, sit-up, crawl and toddle

Birth-36 months



I want...

...to get ready for school by starting to learn the alphabet and counting

...my learning to be as fun, easy and exciting as can be

...to show my creativity with drawing and music so my whole brain develops

3-6 years



Electronic Learning Computers

Cool, aspirational and inspiring computers for curriculum related learning

I need...

...challenging activities that can keep pace with my growing mind

...intelligent technology that adapts to my level of learning

...National Curriculum based content to support what I'm learning at school

4-10 years



To learn more about this and other VTech® products, visit www.vtech.co.uk

INTRODUCTION

Thank you for purchasing the **Rainbow Colours Axolotl Teether**. This cute axolotl is ready to go on any adventure with its colourful lights, textured gills and songs in its heart.

Colourful Textured Gills



Light Up Heart Button

On/Off Switch

INCLUDED IN THE PACKAGE

- Rainbow Colours Axolotl Teether
- Quick Start Guide

WARNING

All packing materials such as tape, plastic sheets, packaging locks, removable tags, cable ties, cords and packaging screws are not part of this toy, and should be discarded for your child's safety.

NOTE

Please save this Instruction Manual as it contains important information.

Unlock the Packaging Locks:

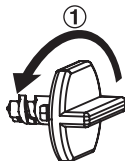

- ① Turn the packaging locks anticlockwise several times.
- ② Pull out and discard the packaging locks.

GETTING STARTED

WARNING:

Adult assembly required for battery installation.

Keep batteries out of reach of children.

Battery Removal and Installation

1. Make sure the unit is turned OFF.
2. Locate the battery cover on the back of the unit. Use a screwdriver to loosen the screw and then open the battery cover.
3. If a used battery is present, remove the battery from the unit by pulling up on one end of the battery.
4. Install 1 new AAA (AM-4/LR03) battery following the diagram inside the battery box. (For best performance, an alkaline battery or fully charged Ni-MH rechargeable battery is recommended).
5. Replace the battery cover and tighten the screw to secure.

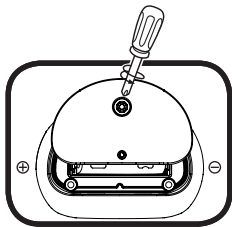

IMPORTANT: BATTERY INFORMATION

- Insert batteries with the correct polarity (+ and -).
- Do not mix old and new batteries.
- Do not mix alkaline, standard (carbon-zinc) or rechargeable batteries.
- Only batteries of the same or equivalent type as recommended are to be used.
- Do not short-circuit the supply terminals.
- Remove batteries during long periods of non-use.
- Remove exhausted batteries from the toy.
- Dispose of batteries safely. Do not dispose of batteries in fire.

RECHARGEABLE BATTERIES:

- Remove rechargeable batteries (if removable) from toy before charging.
- Rechargeable batteries are only to be charged under adult supervision.
- Do not charge non-rechargeable batteries.

Disposal of batteries and product



The crossed-out wheellie bin symbols on products and batteries, or on their respective packaging, indicates they must not be disposed of in domestic waste as they contain substances that can be damaging to the environment and human health.



The chemical symbols Hg, Cd or Pb, where marked, indicate that the battery contains more than the specified value of mercury (Hg), cadmium (Cd) or lead (Pb) set out in the Batteries and Accumulators Regulation.

The solid bar indicates that the product was placed on the market after 13th August, 2005.

Please dispose of your product and batteries responsibly.

In the UK, give this toy a second life by disposing of it at a small electricals collection point* so all of its materials can be recycled.

Learn more at:

www.vtech.co.uk/recycle

www.vtech.com.au/sustainability

PRODUCT FEATURES

On/Off Switch

To turn the unit **On**, slide the **On/Off Switch** to the **On (⏻)** position. You will hear a sound, phrase and a song. To turn the unit **Off**, slide the **On/Off Switch** to the **Off (●)** position.

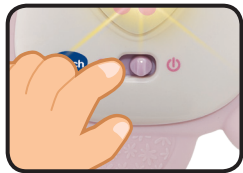

Automatic Shut Off

To preserve battery life, the **Rainbow Colours Axolotl Teether** will enter sleep mode after playing the current response. The unit can be turned on again by pressing the **Light Up Heart Button**.

NOTE

If the unit powers down or if the light fades out during play, please install a new battery.

ACTIVITIES

Light Up Heart Button

Press the **Light Up Heart Button** to hear sweet phrases and cute songs. The light will flash with the sound.



MELODIES

1. A-Tisket, A-Tasket
2. Diddle, Diddle, Dumpling
3. Glow Worm
4. Hey Diddle Diddle
5. London Bridge
6. Pat-a-Cake
7. Rockin' Robin
8. Skip to My Lou
9. Three Little Kittens
10. Yankee Doodle

SONG LYRICS

Song 1

I'm an Axolotl, with two big eyes,
Red, orange, yellow, green, blue, purple.
I love colours!
Won't you sing along with me!

Song 2

We are best friends, and I love you!
I think that you love me too!

Song 3

Music is sweet and so are you!
I like to play and sing with you!

CARE & MAINTENANCE

1. Keep the unit clean by wiping it with a slightly damp cloth.
2. Keep the unit out of direct sunlight and away from any direct heat sources.
3. Remove the battery if the unit will not be in use for an extended period of time.
4. Do not drop the unit on hard surfaces and do not expose the unit to moisture or water.

TROUBLESHOOTING

If for some reason the unit stops working or malfunctions, please follow these steps:

1. Turn the unit **Off**.
2. Interrupt the power supply by removing the battery.
3. Let the unit stand for a few minutes, then replace the battery.
4. Turn the unit **On**. The unit should now be ready to use again.
5. If the unit still does not work, install a brand new battery.

If the problem persists, please call our Consumer Services Department, and a service representative will be happy to help you.

CONSUMER SERVICES

Creating and developing **VTech®** products is accompanied by a responsibility that we at **VTech®** take very seriously. We make every effort to ensure the accuracy of the information, which forms the value of our products. However, errors sometimes can occur. It is important for you to know that we stand behind our products and encourage you to call our Consumer Services Department with any problems and/or suggestions that you might have. A service representative will be happy to help you.

UK Customers:

Phone: 0330 678 0149 (from UK) or +44 330 678 0149 (outside UK)

Website: www.vtech.co.uk/support

Australian Customers:

Phone: 1800 862 155

Website: support.vtech.com.au

NZ Customers:

Phone: 0800 400 785

Website: support.vtech.com.au

PRODUCT WARRANTY/ CONSUMER GUARANTEES

UK Customers:

Read our complete warranty policy online at vtech.co.uk/warranty.

Australian Customers:

VTECH ELECTRONICS (AUSTRALIA) PTY LIMITED –
CONSUMER GUARANTEES

Under the Australian Consumer Law, a number of consumer guarantees apply to goods and services supplied by VTech Electronics (Australia) Pty Limited. Please refer to vtech.com.au/consumerguarantees for further information.

**Visit our website for more
information about our products,
downloads, resources and more.**

www.vtech.co.uk

www.vtech.com.au

